

# SmartLIGHT

## RGBW PAR CANS

Item ref: SL-FC3, SL-36, SL-64, SL-SW, SL-Q8, SL-Q12

User Manual



**SL-FC3**  
154.000



**SL-36**  
154.005



**SL-64**  
154.007

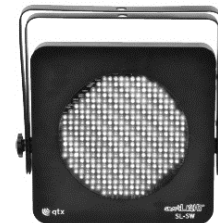

**SL-SW**  
154.008



**SL-Q8**  
154.009



**SL-Q12**  
154.010

*Errors and omissions excepted.  
Copyright© 2012. AVSL Group Ltd.*

**VERSION 1.0**

## **INTRODUCTION:**

### **LED SMARTLIGHT RGBW PAR CANS**

The QTX SmartLIGHT family of LED Par cans have been designed for a variety of applications, whether you're a mobile DJ, a band/singer, a bar/nightclub, theater company or production company then this range of PAR cans will cover most requirements.

Please read this manual carefully to ensure you get the best out of these products.

This manual covers the following models:

SL-36, SL-64, SL-SW, SL-Q8 and SL-FC3

### **Contents:**

Page 3 – 6    Product Safety and Installation instructions

Page 7 – 9    SmartLIGHT Product layout

Page 10 – 11    SmartLIGHT Operation and functions

Page 12 – 13    SmartLIGHT DMX Operation

Page 14 – 16    SL-FC3 Controller Operations

Page 17        Product Specifications

**PACKAGE CONTENTS:**

Please check the contents to ensure that the product has been received in good condition.

SmartLIGHT Box:

SmartLIGHT Unit x 1pcs	User's Guide x 1pcs
Power Cord x 2pcs (EU and UK)	Mounting brackets x 2pcs

Controller Box:

SL-FC3 Controller x 1pcs	5m cable x 1pcs	User's Guide x 1pcs
--------------------------	-----------------	---------------------

If you find any accessory is missing or the product has arrived with any problems, please contact your local dealer at once. Do not try to fix this item yourself or you will lose the warranty. Please keep the original package and invoice for any possible replacement or returned demand.

**INSTALLATION:**

Every person involved with the installation, operation and maintenance of this device should be qualified and follow the instructions in this User Guide. We recommend that this product should be used within the guidelines of "HSG95". When you connect to the main power supply the device will take a few seconds before ready for use.

**MOUNTING INSTRUCTIONS:**

The mounting brackets are already attached to the product when you open the box but you can adjust them giving more clearance. You can use them as floor standing or you can fix a G-Clamp to the bracket securely ready for mounting. After finding the desired position tighten the G-Clamp and use a safety wire the security loop for extra security.

When selecting an installation location, take into consideration routine maintenance. Safety cables must always be used. Never mount in places where the fixture will be exposed to rain, high humidity, extreme temperatures changes or restricted ventilation.

**CAUTION! TO PREVENT MORTAL ELECTRICAL RISK AND LONG LIFE OPERATION:**

For your safety, please kindly pay attention to all of the warnings listed below:

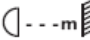
- Always plug in the power plug last and disconnect from the mains, when the device is not in use or before cleaning.
- Do not install and operate the device in rain or extreme heat, moisture or dusty environments.
- This device is for indoor use only and in a dry environment.
- Do not switch on immediately but wait until it reaches to room temperature, if the device has been exposed to drastic temperature fluctuations.
- Do not shake the device and avoid brute force when installing or operating.
- Do not spread a fog or bubble effect machine directly at the device.
- Do not use the device during thunderstorms. Disconnect the power.
- Do not use solvents or aggressive detergent to clean the device. Use a soft and clean cloth.
- Do not modify the device or the power cord in anyway.
- Use appropriate safety-rope for added safety.
- Do not stare to the light.
- The symbol  determines the minimum distance from lighted objects. The minimum distance between light-output and the illuminated surface must be more than 0.5m.

**TECHNICAL SPECIFICATION:**

Model	Power Consumption	Beam Angle	LED Type	LED Data	Dimensions	Weight
SL-36	10W	135°	5mmØ	60 (R:15, G:12, B:15, W:18)	150 x 160 x 120mm	1.15kg
SL-64	25W	25°	10mmØ	167 (R:43, G:44, B:40, W:40)	270 x 275 x 70mm	2.1kg
SL-5W	35W	135°	5mmØ	381 (R:97, G:96, B:98, W:90)	270 x 275 x 70mm	2.15kg
SL-Q8	100W	35°	4 in 1 12W Quad Colour	8 x (4 in 1 quad colour)	240 x 240 x 80mm	2.85kg
SL-Q12	160W	35°	4 in 1 12W Quad Colour	12 x (4 in 1 quad colour)	270 x 270 x 90mm	3.15kg

For more information visit [www.avsl-qtx.com](http://www.avsl-qtx.com)

**DISPOSAL:**



Please disposal of an unserviceable device according to the current statutory requirement

## LED FOOT CONTROLLER OPERATION:

**Colour**

**Mode**

**Blackout**

Power on

White	Colour Scroll	When Blackout button is pressed the current Display Flashes on & off to indicate blackout button is in use
Red	Sound to light all one colour	
Green	Sound to light colour chase	
Blue	All Strobe White	
Purple	Chase colour strobe	
Cyan		
Yellow		
Pink		
Orange		
Lime		

## CONNECT WITH POWER SUPPLY – THE GROUND WIRE MUST BE CONNECTED:

Use the IEC plug to connect to the main power supply as follows:

Wire	Connection	International signal
Brown	Live	L
Blue	Neutral	N
Yellow /Cyan	Earth	

## QUICK TROUBLE SHOOTING

If the unit is not functioning properly follow the below guidelines

- Check the IEC cable is fitted correctly.
- Check the fuse hasn't blown in both the IEC cable and unit (see below)
- Check any DMX cables are connected correctly
- Check the DMX address has been set correctly
- Check the operating mode of the device (see later on in this manual)

If the unit still fails to respond then contact your retailer. **DO NOT ATTEMPT TO REPAIR YOURSELF.**

## REPLACING FUSE

First disconnect from the main power supply then remove the fuse holder above the IEC Socket to reveal the fuse. Replace with the correct fuse rating as stated on the product safety label. Then lock the fuse holder cover back into place.

## GENERAL MAINTENANCE

To maintain optimum performance and minimise wear, fixtures should be cleaned frequently. Usage and environment are contributing factors in determining frequency. As a general rule, fixtures should be cleaned at least twice a month. Dust build-up reduces light output performance and can cause overheating. This can lead to reduced life and increased mechanical wear. Be sure to power off the fixture before conducting maintenance.

Unplug fixture from the mains and use a vacuum or air compressor and a soft brush to remove dust collected on external vents and internal components. Clean all glass and Perspex when fixture is cold with a mild cleaning solution to the cloth or tissue, and drag dirt and grime to the outside of the lens. Gently polish optical surface until they free of haze and lint.

The cleaning of external optical lenses must be carried out periodically to optimise light output. Cleaning frequently depends on the environment in which the fixture operates: damp, smoky or particularly dirty surroundings can require cleaning fluid. Always dry the parts carefully. Clean the external optics at least every 20 days.

Once all the fixtures are setup turn the power on and set the DMX address on each model to A001.

For users who wish to use the sound to light 4 light chase sequences set the DMX to each of the following:

Connecting in 4's

1<sup>st</sup> PAR can = A001

2<sup>nd</sup> PAR can = A007

3<sup>rd</sup> PAR can = A013

4<sup>th</sup> PAR can = A019

If you are connecting more than four in a chain either start again or work backwards. Maybe try your own combination but note you may only connect up to a maximum of 32 PAR cans in any one sequence.

### SL-FC3 FOOT CONTROLLER:

A combination of up to 32 SmartLIGHT fixtures can be operated by one SL-FC3 controller.

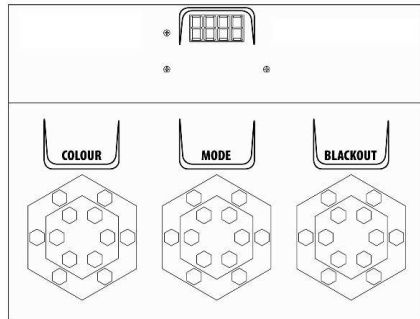

### SETUP:

First connect the foot controller to the first fixture using the supplied cable as shown below. Connecting more than one fixture to the chain requires 3 pin DMX XLR Leads (available at most retailers).

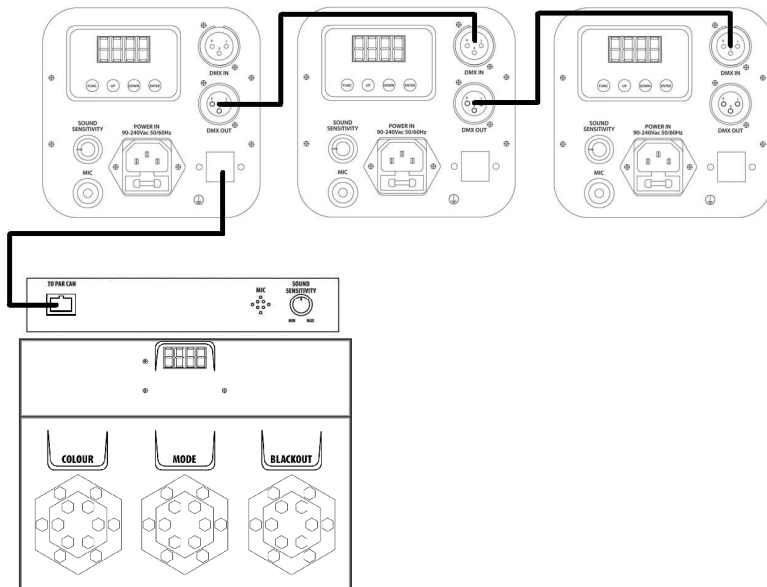

### FRONT LAYOUT GENERAL:

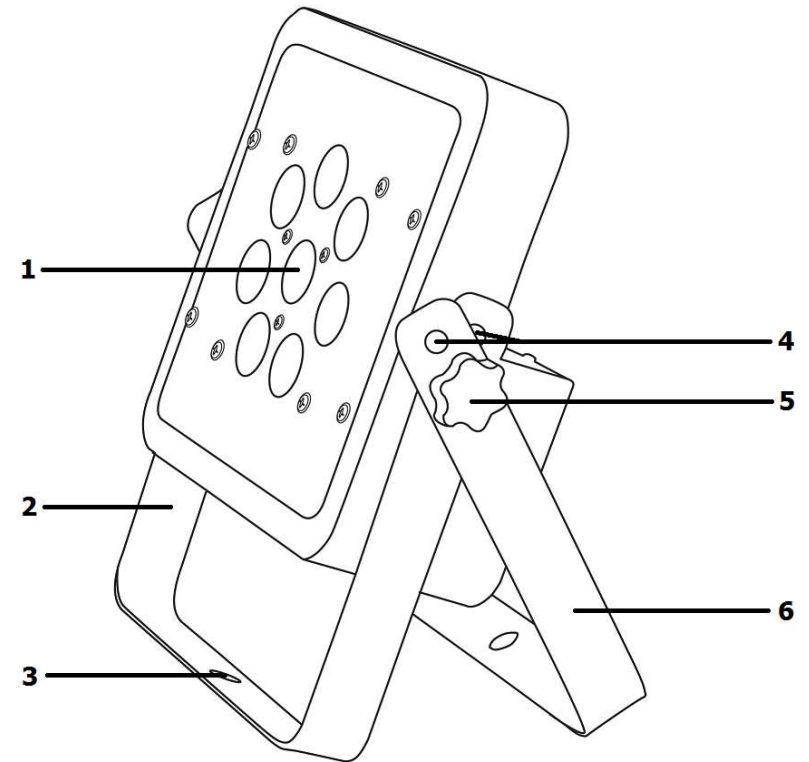

1. LED Output
2. Secondary bracket
3. Mounting point for G-Clamp
4. Secondary mounting points for more clearance
5. Thumb screw to hold brackets in place
6. Primary bracket

**REAR LAYOUT SL-36:**

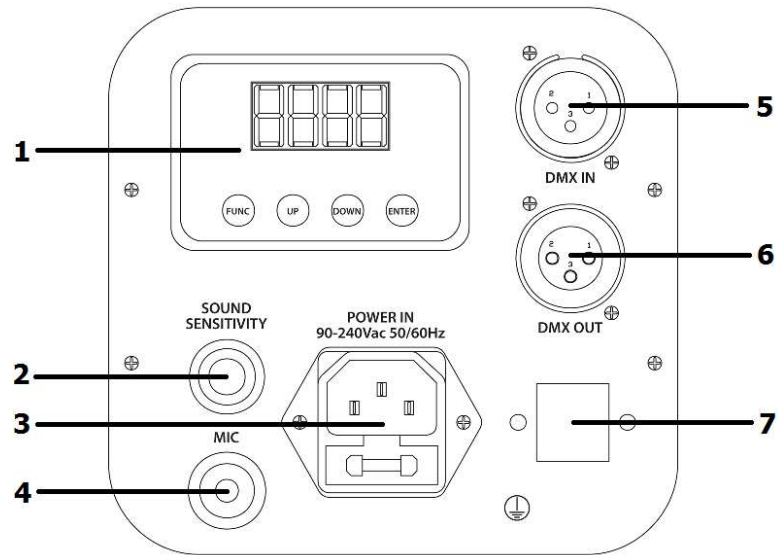

1. LED Display
2. Sound sensitivity
3. IEC Power IN (Fuse F1A)
4. Microphone
5. DMX IN
6. DMX OUT
7. Connection to SL-FC3 Foot controller (sold separately)

**DMX OPERATIONS:**

DMX Channel	DMX Value	Function
1	000-255	Red Colour 0-100% Dimming
2	000-255	Green Colour 0-100% Dimming
3	000-255	Blue Colour 0-100% Dimming
4	000-255	White Colour 0-100% Dimming
5	000-255	Master Dimming 0-100%
6	000-250	Strobe Slow to Fast
	251-255	Sound Activated



## DMX

The fixture is equipped with 3-pin XLR connectors for DMX input and output. The SE connectors are wired in parallel. Only use a shielded twisted-pair cable designed for 3-pin XLR-plugs and connectors in order to connect the controller with the fixture or one fixture with another.

DMX - output  
XLR mounting-sockets (rear view):



DMX-input  
XLR mounting-plugs (rear view):

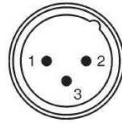

- 1 - Shield
- 2 - Signal (-)
- 3 - Signal (+)

Building a serial DMX-chain:

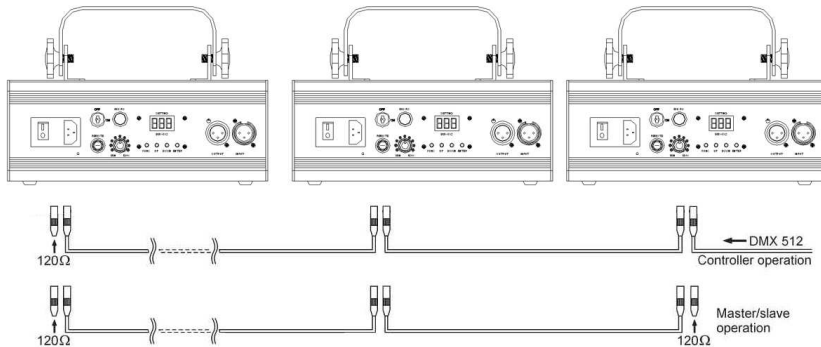

**Caution:** At the last fixture, the DMX-cable has to end with a terminator. Solder a 120 Ohm resistor between PIN 2 (-) and PIN 3 (+) into a 3-pin XLR-plug and plug it in the DMX-output of the last fixture.

## REAR LAYOUT SL-64, SL-SW, SL-Q8 and SL-Q12:

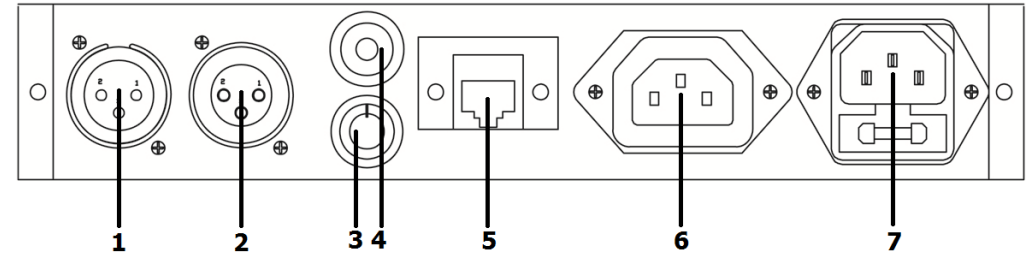

1. DMX IN
2. DMX OUT
3. Sound sensitivity
4. Microphone
5. Connection to SL-FC3 Foot controller (sold separately)
6. IEC Power OUT
7. IEC Power IN (Fuse F1A and F3A for SL-Q12)

**CONTROL DISPLAY:**

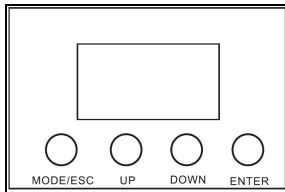

1. MODE\ESC: Menu or withdraw the last menu
2. UP: Increase one step each time
3. DOWN: Decrease one step each time
4. ENTER: Confirms the functions you select

\*Note the display will turn off if no activity for 20 seconds.

**PRIMARY FUNCTION:**

LED Display	Action
Sund	Sound to light mode
AUTO	Auto programs
CLOr	Pre-set colours
dISP	Display normal
dSIP	Inverted display
Addr	Set DMX address

**SECONDARY FUNCTION:**

<b>A001-A512</b>	DMX-512 Address from 1 to 512
<b>Er_L</b>	If there is a breakdown in the DMX connection
<b>AUT1</b>	Auto color switch
<b>AUT2</b>	Auto color switch , fade in & fade out effect (slow fade in – slow fade out)
<b>AUT3</b>	WRGB Color Scroll, fade in & fade out (slow fade in – quick fade out)
<b>AUT4</b>	Auto color mixing, Pastel scroll
<b>SOU1</b>	Sound Activated with colour changing mode
<b>SOU2</b>	Sound to light strobe all LEDs on. 3 flashes per beat
<b>SOU3</b>	Sound to light blast color switch quick fade in slow fade out

**MASTER/SLAVE:**

If you have more than one unit you wish to operate the same but do not have a DMX controller or foot controller then you can do so in the following simple way: Connect a 3 pin DMX XLR cable from the DMX OUT socket on the master unit and plug in to the DMX IN socket on the slave device. Then set the Slave device to DMX address to be A001 and it will repeat whatever operation is current on the master unit. This can be repeated for up to 32 fixtures.