



### MG Series

#### Key Features

Premium Active loudspeaker

15 Inch high performance low-frequency driver

3 Inch voice coil

90° x 60° coverage

Professional XLR and 1/4" combo jack,  
with XLR loop-through

Amplifier with cooling fan

Twelve M10 suspension points



#### Frequency Response & Impedance

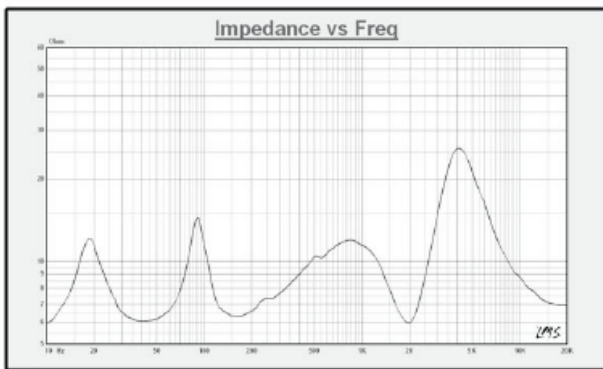
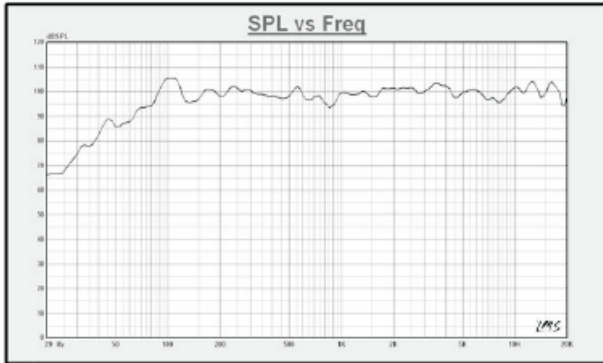

#### Specifications

Frequency Range (-10dB): 42 Hz ~ 20 kHz

Frequency Response ( $\pm 3$ dB): 48 Hz ~ 19 kHz

Coverage Pattern: 90° x 60°

Crossover Frequency: 2.5 kHz

Power Rating: 350W / 700W

Maximum SPL: 130 dB

LF Driver: 3" voice coil

HF Driver: 1" compression driver

Nominal Impedance: Passive: 8 ohm

Enclosure: Trapezoidal, MDF

Suspension / Mounting: 12 x M10 suspension points

Transport: 2 Side recessed handle

Finish: Black painting

Grille: Powder coated, with acoustical  
transparent charcoal foam backing

Amplifier type: Class AB

Input Connectors: XLR and 1/4" combo jack  
with XLR loop through

Dimensions (W x D x H): 432x415x670(mm) / 17x16.3x26.4 (in)

Net Weight: 29 Kgs / 64 Lbs

# MG-115A 15 Inch Active Two-Way Stage Monitor/Utility Speaker

## Block Diagram

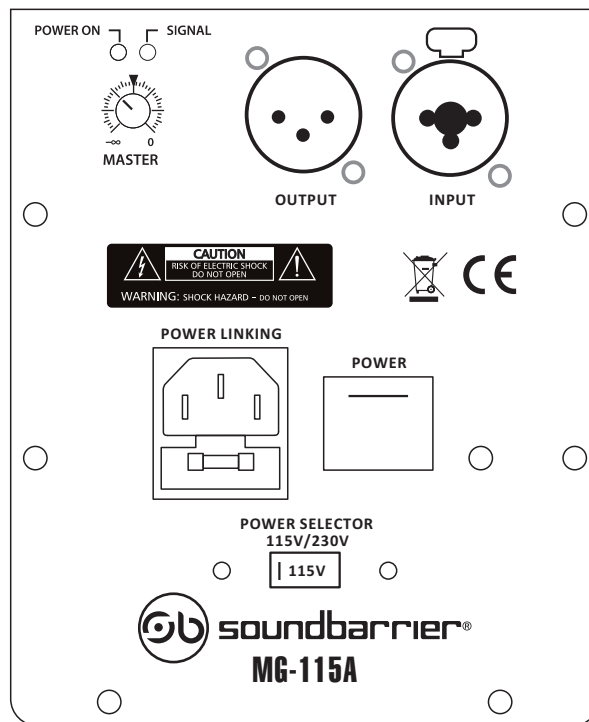

## Dimensions

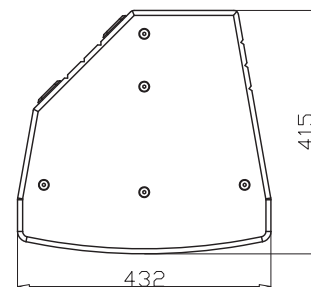
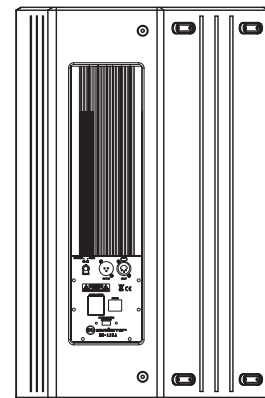
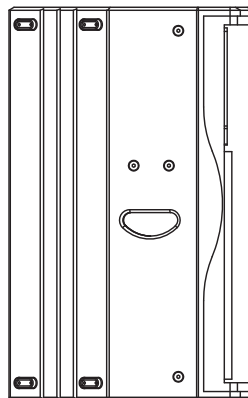
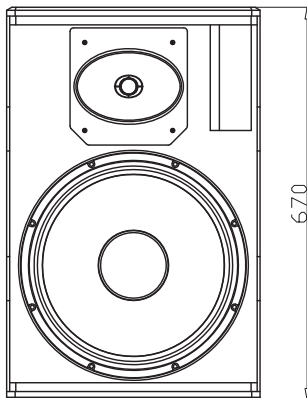

CARIBBEAN ELECTRONIC ENTERPRISES, INC.  
7091 N.W. 51 STREET, MIAMI, FL 33166, USA

[www.soundbarrier.com](http://www.soundbarrier.com)